

# BOX-13

**Built-in thermostatic mixer  
with 2 -way diverter & fixed outlet socket  
Designer: John Pawson**



COCOON

John Pawson  
Built-in thermostatic mixer  
with 2 -way diverter & fixed outlet socket

Technical  
Specification  
Sheet

# BOX-13

1/2" connection to copper, steel, iron or pex pipe work

Dimensioned drawing 1/2

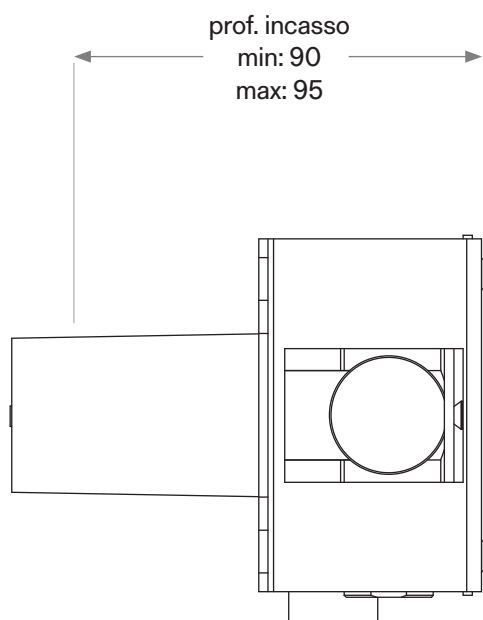
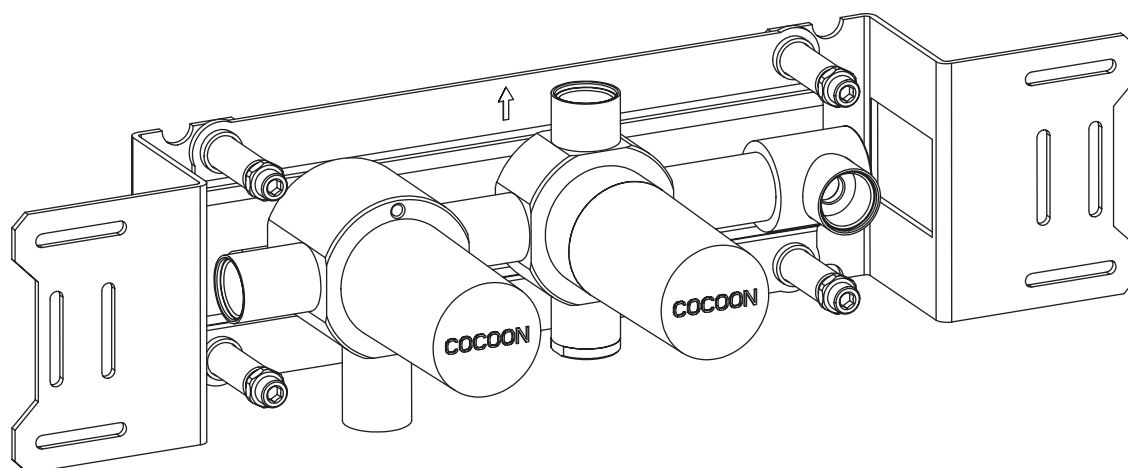

John Pawson  
Built-in thermostatic mixer  
with 2 -way diverter & fixed outlet socket

Technical  
Specification  
Sheet

**BOX-13**

1/2" connection to copper, steel, iron or pex pipe work

Dimensioned drawing 2/2

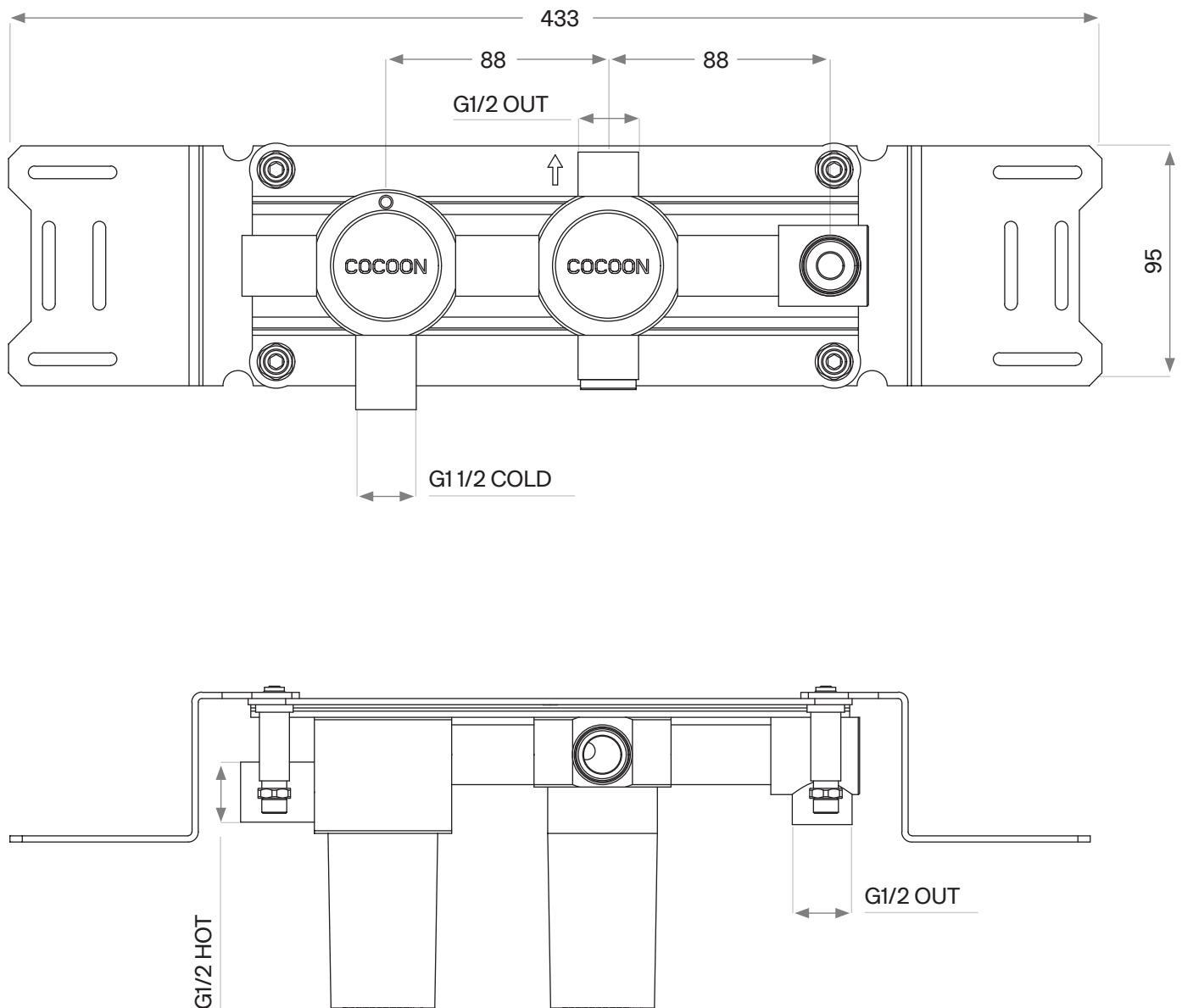

## Spare Parts List 1/2

Part no	Spare part code	Article No	Description	QTY
1.	BOX13-001	BOX13-001.000	M4 X 20	1
2.	BOX13-002	BOX13-002.000	Spindle connection for thermostatic valve	1
3.	BOX13-003	BOX13-003.000	Plastic part for temperature setting	1
4.	BOX13-004	BOX13-004.000	Pin	2
5.	BOX13-005	BOX13-005.000	Retaining ring	1
6.	BOX13-006	BOX13-006.000	Dowel	1
7.	BOX13-007	BF26900	Thermostatic valve S18	1
8.	BOX13-008	BOX13-008.000	Grub screw M4 X 35	1
9.	BOX13-009	BOX13-009.000	Spindle connection for diverter	1
10.	BOX13-010	BOX13-010.000	Retaining ring	1
11.	BOX13-011	BF15109	Diverter	1
12.	BOX13-012	31411400001	Back-flow preventer	2
13.	BOX13-013	BOX13-013.000	C-clip bucket	2
14.	BOX13-014	BOX13-014.000	Build-in body	1
15.	BOX13-015	BOX13-015.000	Mounting frame	1
16.	BOX13-016	BOX13-016.000	Screw M4 X 8	5

John Pawson  
Built-in thermostatic mixer  
with 2 -way diverter & fixed outlet socket

Technical  
Specification  
Sheet

**BOX-13**

**Installation Manual**

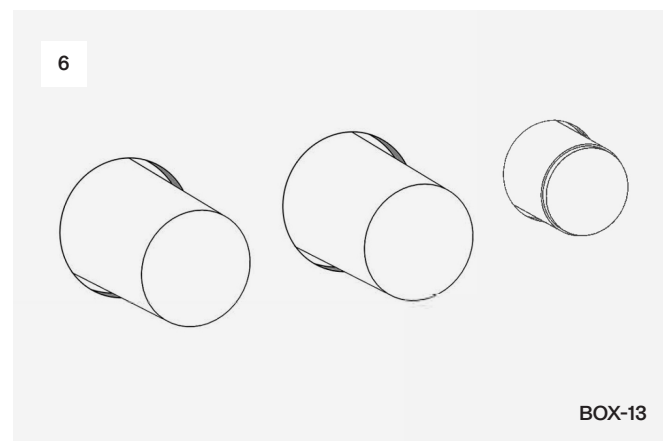
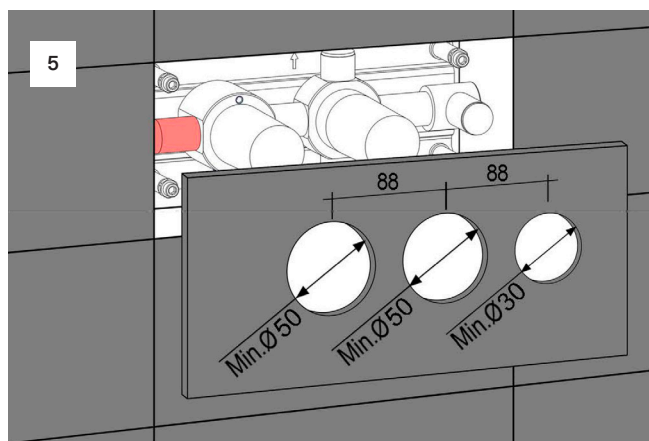
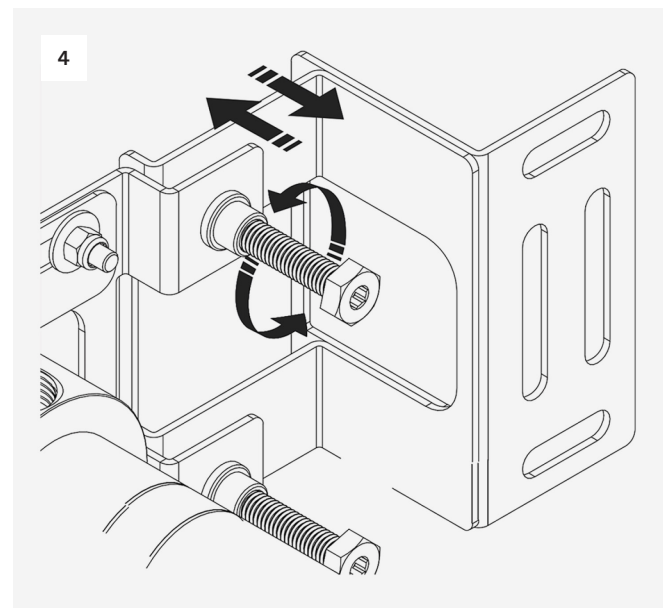
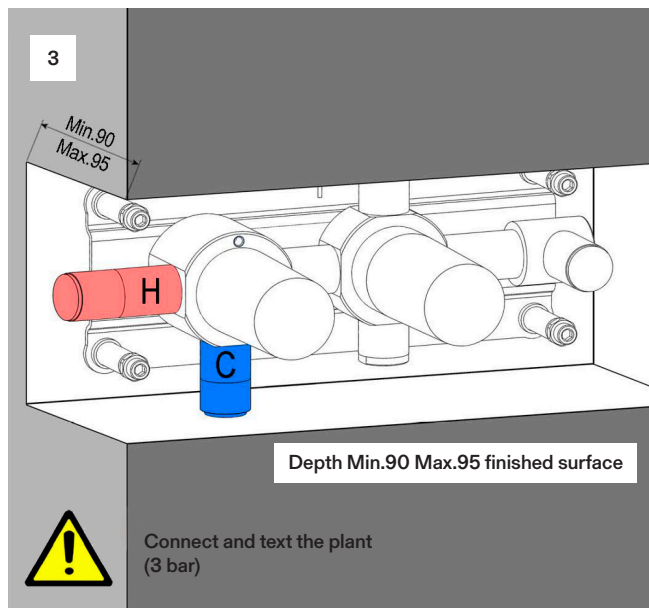
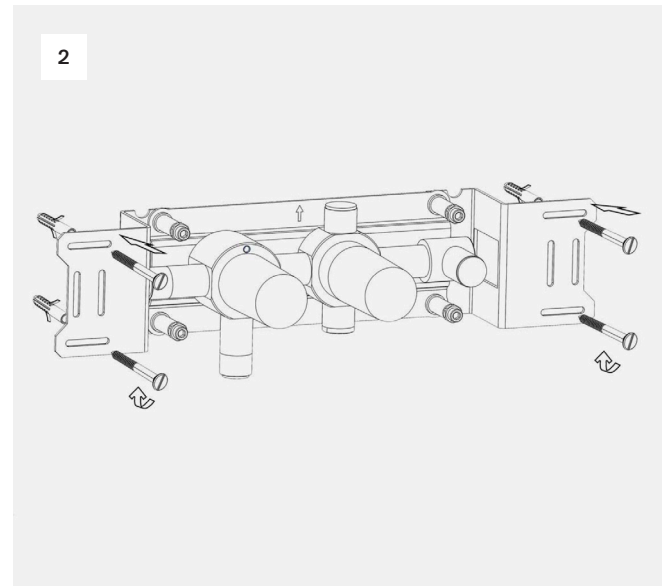
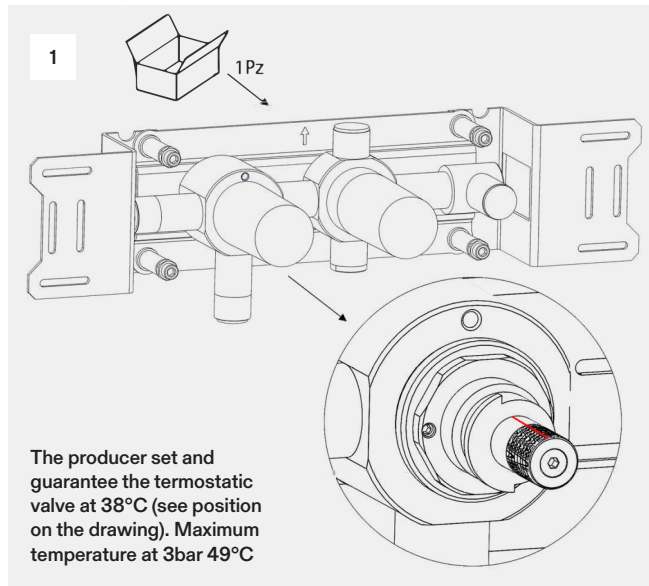

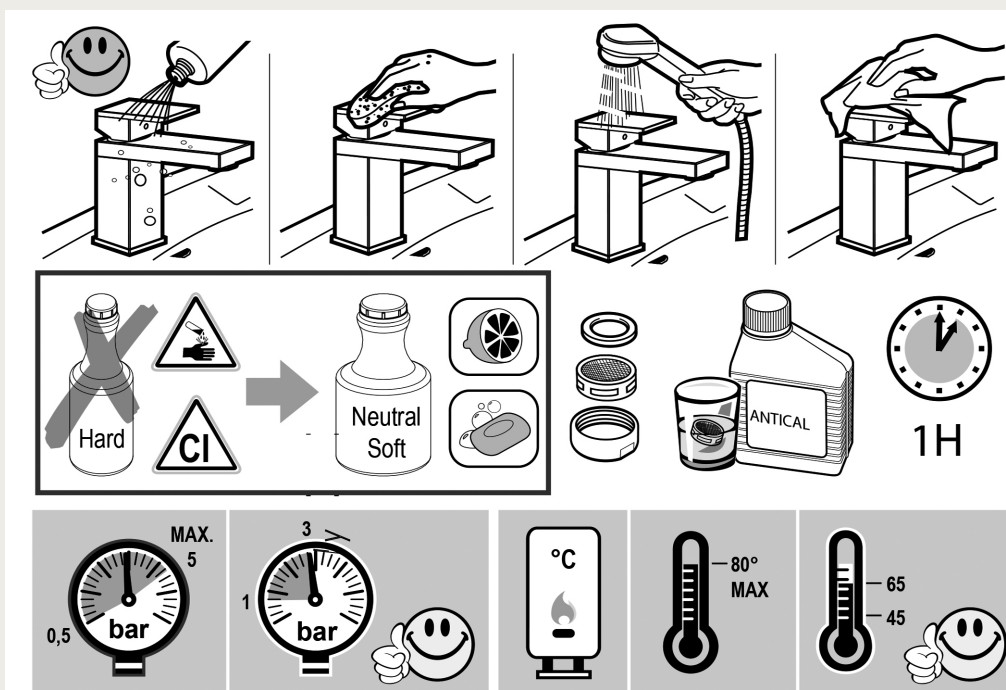

## Please ensure you comply with the following instructions to optimise performance of the mixer:

- All pipework must be thoroughly flushed prior to installation
- For USA installation, please fix the USA NPT adapters on top of the pre-installed water connections
- Always first test the system with water pressure before closing the walls
- Optimal water pressure 3 BAR / temperature should not exceed 65°C/149°F
- Please read all installation instructions carefully

**Failure to comply with manufacturers recommendations will void warranty**